

Suite Information:

2 Bedroom Suite with Parlour (booked by email):



Parlour only – 500 sft

2 BEDROOM PARLOUR

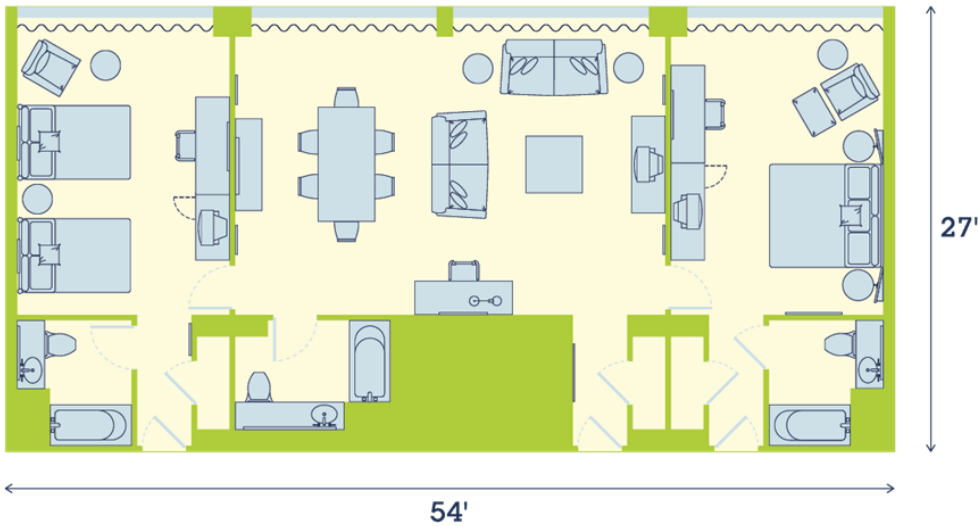

Regular Floor:

\$927 + tax per night

8 available

Club Floor:

\$1,227 + tax per night

4 available

Club Lounge Information:

- Open on weekdays from 6:30 am-10:00 pm & weekends from 7:00 am-10:00 pm
- Deluxe hot breakfast is served Monday – Friday from 6:30-10:00 am and Saturday & Sunday from 7:00-11:00 am
- Snacks and beverages are available throughout the day
- Evening hors d'oeuvres served daily from 5:00-8:00 pm with alcohol for purchase
- Copier, printer and complimentary office supplies are available

Smaller Suites (booked by phone or on-line):

Self-Contained Open Concept (BLP) Suite:

~ 500 sft

\$309 + tax per night

10 available



Self-Contained Regular Suite:

~ 520 sft

\$309 + tax per night

10 available



NOTE: If you are using the smaller suite for hospitality you should consider booking the bedroom on either side of the suite for noise control (an additional \$229 +tax per night per room).